

NOTES:

1. SUBSTRATE
2. SURFACE S2 TO BE PARALLEL WITH SURFACE S1 TO WITHIN 10 ARCSEC
3. COATING (APPLY ACROSS CLEAR APERTURE)
PHYSICAL DURABILITY: MIL-C-48497A
ENVIRONMENTAL DURABILITY: MIL-STD-810F
Tavg ≥93% @ 521.2 - 1160.5nm
4. FINE GROUND SURFACE
5. POWER, IRREGULARITY, AND SURFACE QUALITY SPECIFICATIONS APPLY
ACROSS CLEAR APERTURE
6. TRANSMITTED WAVEFRONT DISTORTION RMS @ <λ/4 @ 633nm
7. RoHS COMPLIANT

**FOR INFORMATION ONLY:
DO NOT MANUFACTURE
PARTS TO THIS DRAWING**

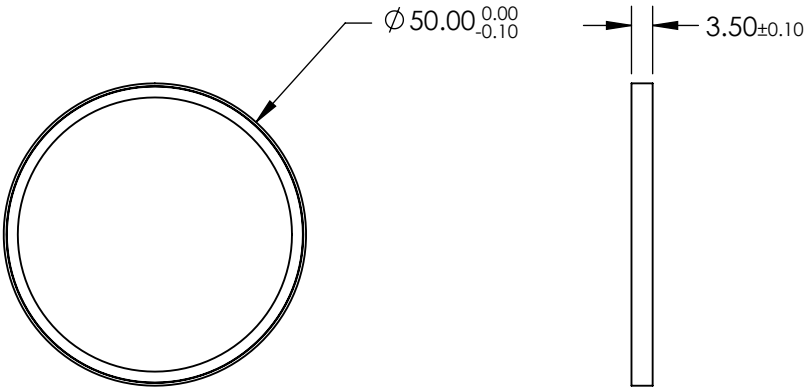
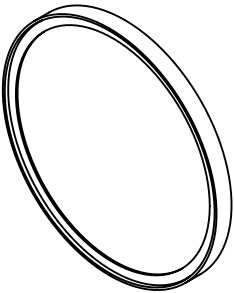

SPECIFICATIONS SUBJECT TO CHANGE WITHOUT NOTICE
DIMENSIONS ARE FOR REFERENCE ONLY

REV. A	S1	S2	<div><div><div><div><div></div></div></div><div><div></div></div></div><div>THIRD ANGLE PROJECTION</div></div> <div><div>Edmund Optics®</div><div>Edmund Optics®</div></div>			
SHAPE	PLANO	PLANO				
REJECTION WAVELENGTH	416 - 514.5	416 - 514.5				
SURFACE QUALITY	60-40	60-40				
CLEAR APERTURE	Ø40	Ø40				
BEVEL	PROTECTIVE AS NEEDED	PROTECTIVE AS NEEDED				
			ALL DIMS IN	mm	TITLE	Ø50mm, 519.6nm, RAMAN EDGE FILTER
			DWG NO		86258	SHEET 1 OF 1