

NOTES:

1. SUBSTRATE MATERIAL:
ALUMINUM
2. FINISH (EXCEPT SURFACE S1):
BLACK ANODIZED
3. COATING (APPLY ACROSS CLEAR APERTURE)
S1: PROTECTED GOLD
R(AVG) >94% @ 700 - 800nm
R(AVG) >97% @ 800 - 2000nm
R(AVG) >98% @ 2000 - 12000nm

SURFACE ROUGHNESS: <175 Å RMS
4. FOCAL LENGTH TOLERANCE: ±1%
5. ROHS COMPLIANT

**FOR INFORMATION ONLY:
DO NOT MANUFACTURE
PARTS TO THIS DRAWING**

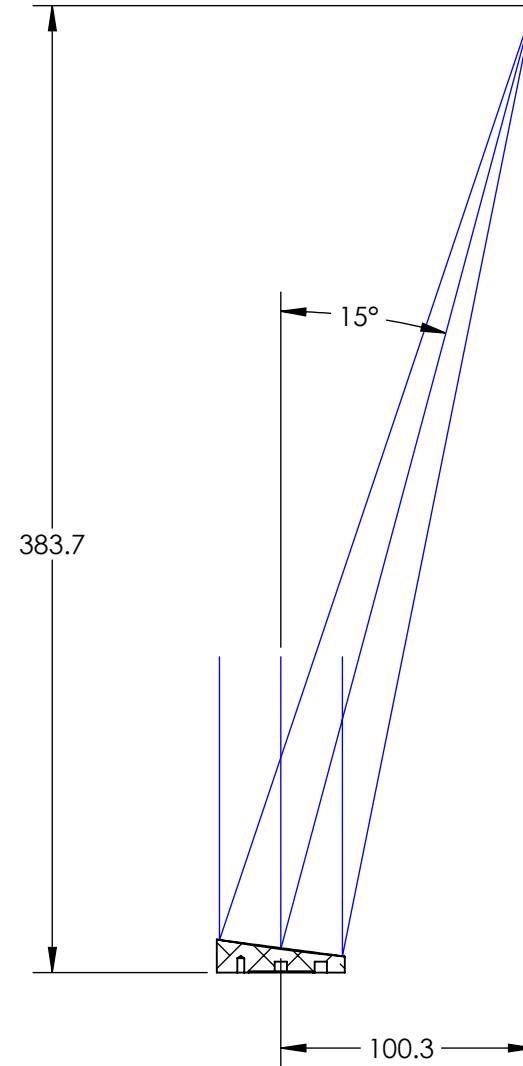
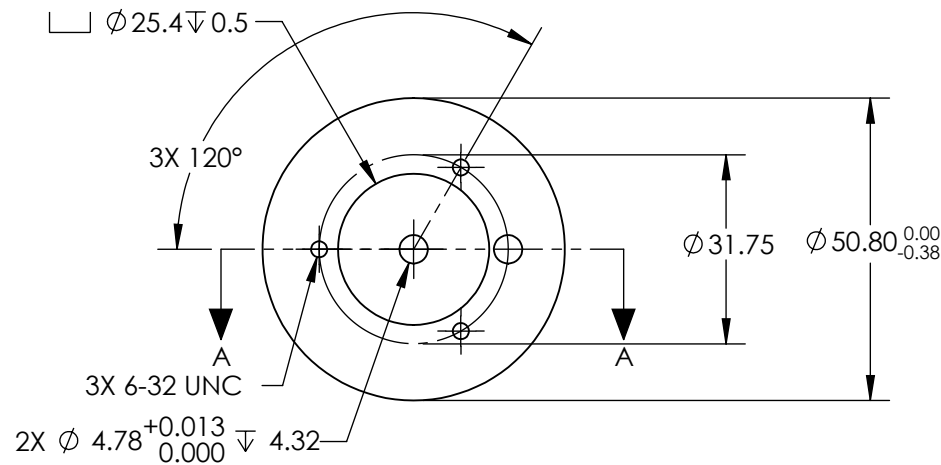
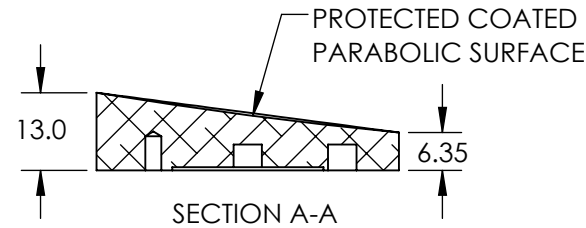

SPECIFICATIONS SUBJECT TO CHANGE WITHOUT NOTICE
DIMENSIONS ARE FOR REFERENCE ONLY

| REV. A | S1 |
|---|----------------------|
| SHAPE | PARABOLIC |
| REFLECTIVE WAVEFRONT DISTORTION AT 632.8nm (RMS) | 1λ |
| SURFACE FIGURE AT 632.8nm (RMS) | λ/2 |
| CLEAR APERTURE | 90% |
| BEVEL | PROTECTIVE AS NEEDED |

THIRD ANGLE
PROJECTION

ALL DIMS IN mm

| | |
|--------|--|
| | |
| TITLE | Ø50.8 X 387.6mm EFL 15° OFF-AXIS PARABOLIC GOLD MIRROR 175A |
| DWG NO | 84560 |
| SHEET | 1 OF 1 |