

NOTES:

- SUBSTRATE MATERIAL:
ALUMINUM
- FINISH (EXCEPT SURFACE S1):
BLACK ANODIZED
- COATING (APPLY ACROSS CLEAR APERTURE)
S1: PROTECTED GOLD
R(AVG) >94% @ 700 - 800nm
R(AVG) >97% @ 800 - 2000nm
R(AVG) >98% @ 2000 - 12000nm

SURFACE ROUGHNESS: <175 Å RMS
- FOCAL LENGTH TOLERANCE: ±1%
- ROHS COMPLIANT

**FOR INFORMATION ONLY:
DO NOT MANUFACTURE
PARTS TO THIS DRAWING**

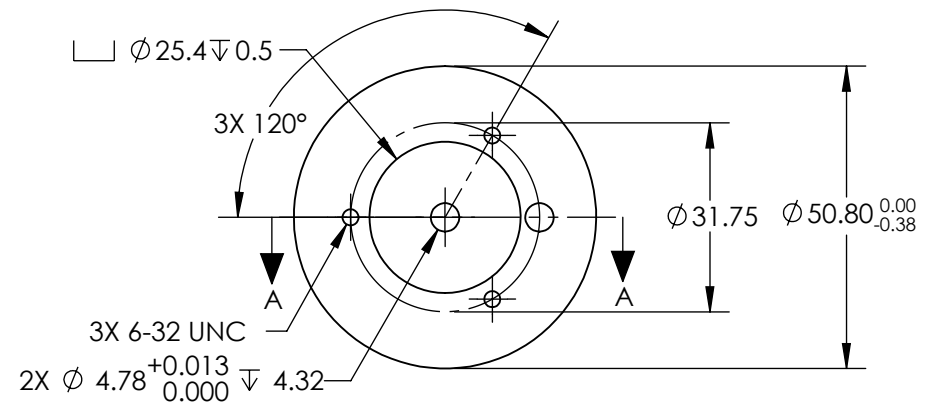
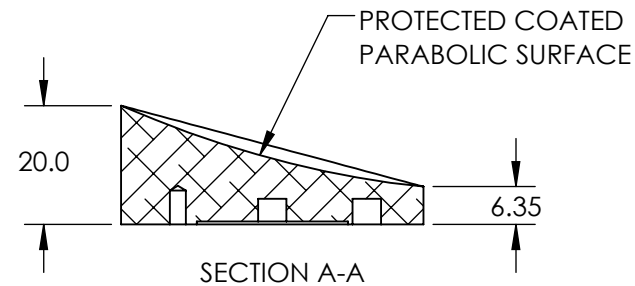
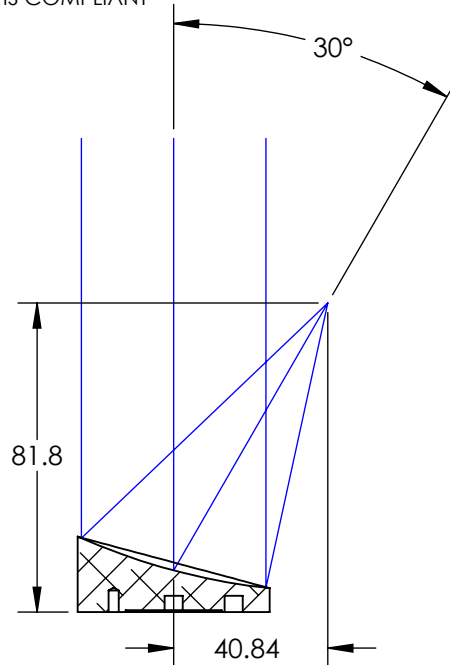
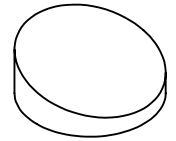

SPECIFICATIONS SUBJECT TO CHANGE WITHOUT NOTICE
DIMENSIONS ARE FOR REFERENCE ONLY

REV. A	S1
SHAPE	PARABOLIC
REFLECTIVE WAVEFRONT DISTORTION AT 632.8nm (RMS)	1λ
SURFACE FIGURE AT 632.8nm (RMS)	λ/2
CLEAR APERTURE	90%
BEVEL	PROTECTIVE AS NEEDED

		Edmund Optics®	
THIRD ANGLE PROJECTION		TITLE	Ø50.8 X 81.67mm EFL 30° OFF-AXIS PARABOLIC GOLD MIRROR 175A
ALL DIMS IN	mm	DWG NO	84575
			SHEET 1 OF 1