

NOTES:

1. SUBSTRATE MATERIAL:
N-SF5
2. COATING (APPLY ACROSS CLEAR APERTURE)

S1: PROTECTED GOLD
R(avg) >89% @ 250 - 450nm
R(avg) >94% @ 700 - 800nm

S2: NONE

3. POWER, IRREGULARITY, SURFACE QUALITY, AND COATING
SPECIFICATIONS APPLY ACROSS CLEAR APERTURE

4. FINE GROUND SURFACE

5. ROHS COMPLIANT

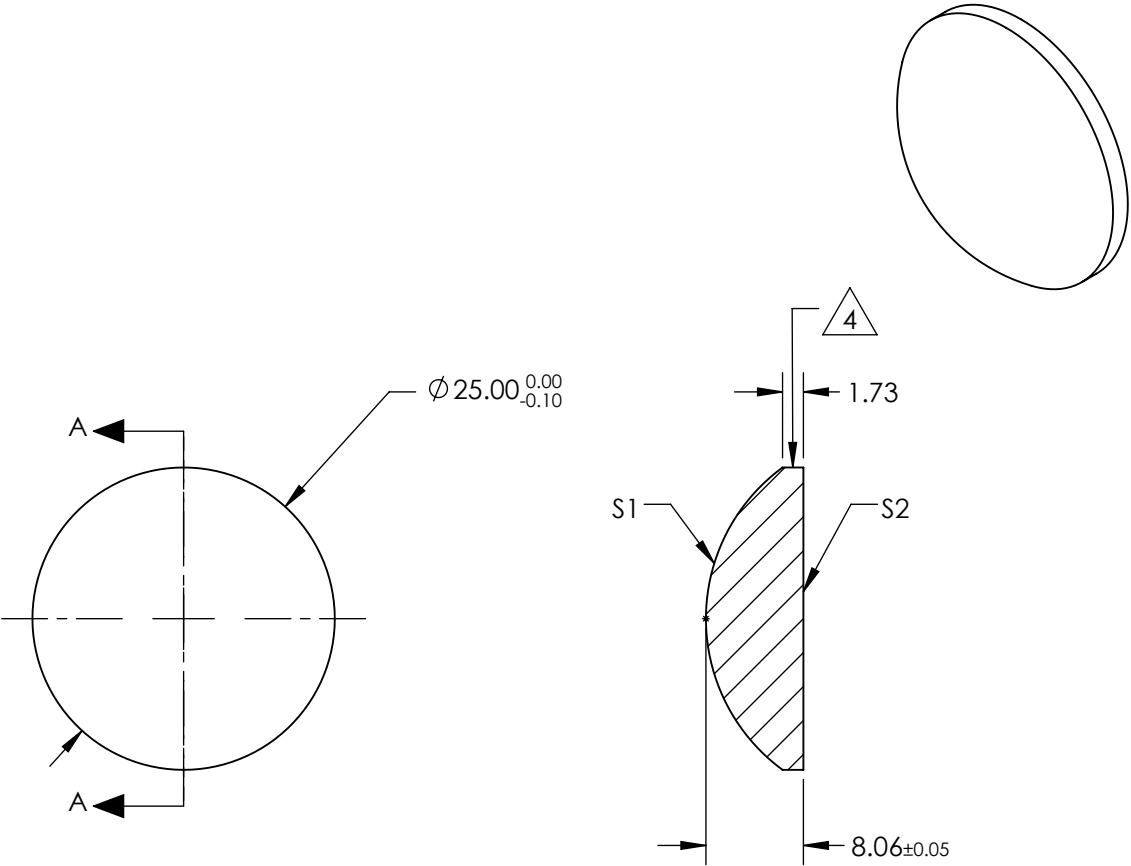

SECTION A-A

**FOR INFORMATION ONLY:
DO NOT MANUFACTURE
PARTS TO THIS DRAWING**

SPECIFICATIONS SUBJECT TO CHANGE WITHOUT NOTICE
DIMENSIONS ARE FOR REFERENCE ONLY

REV. A	S1	S2
SHAPE	CONVEX	PLANO
RADIUS	15.5	INFINITY
EFFECTIVE FOCAL LENGTH	-7.75mm	N/A
FOCAL LENGTH TOLERANCE	±2%	N/A
SURFACE QUALITY	60-40	COMMERCIAL POLISH
CLEAR APERTURE	90%	N/A
BEVEL	PROTECTIVE AS NEEDED	PROTECTIVE AS NEEDED

THIRD ANGLE PROJECTION	TITLE	Ø25mm, -7.75mm FL PROTECTED GOLD, CONVEX SPHERICAL MIRROR	
ALL DIMS IN	mm	DWG NO	64074
		SHEET 1 OF 1	

Edmund Optics®