

NOTES:

- SUBSTRATE: N-SF5
- COATING (APPLY ACROSS CLEAR APERTURE)
S1: R(avg) ≤1.5% @ 600 - 1050nm
S2: R(avg) ≤1.5% @ 600 - 1050nm
- EDGES: FINE GROUND
- CENTERING: 3-5 ARCMIN
- ASPHERE FIGURE ERROR: 0.75 μm RMS

△6. ASPHERIC SURFACE DESCRIBED BY (REF. COEFFICIENT TABLE)

$$Z_{ASPH}(Y) = \frac{(1/RADIUS)^*Y^2}{1 + \sqrt{1 - (1+k)*(1/RADIUS)^2*Y^2}} + D*Y^2 + E*Y^4 + F*Y^6 + G*Y^8 + H*Y^{10} + J*Y^{12} + L*Y^{14}$$

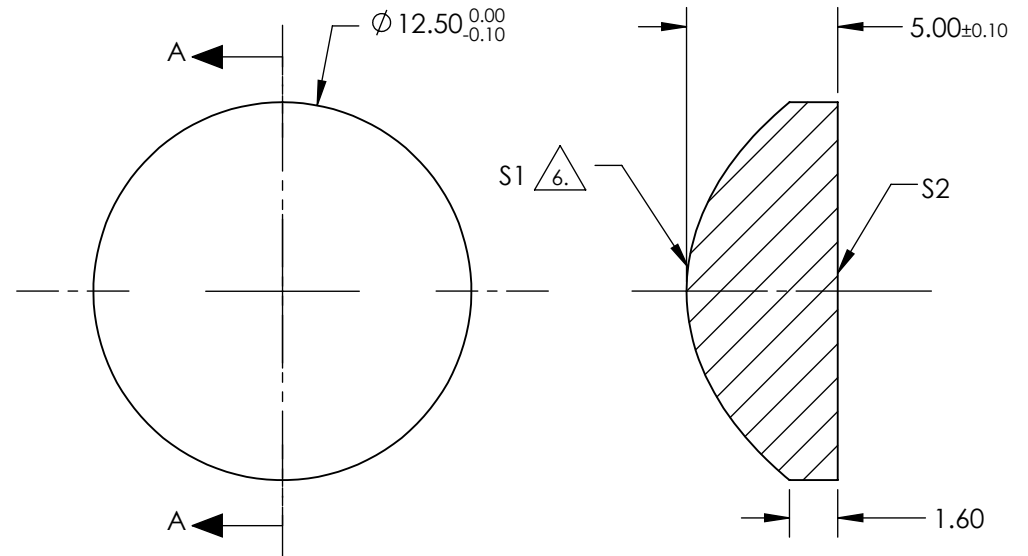

SECTION A-A

COEFFICIENT TABLE △6.

COEFFICIENT	S1
SEMI-DIAMETER	6.250000E+00
(1/RADIUS)	1.564700E-01
k	-1.186336E+00
D	0.000000E+00
E	3.013148E-04
F	3.801752E-07
G	-1.468960E-09
H	-7.154329E-11
J	0.000000E+00
L	0.000000E+00

**FOR INFORMATION ONLY:
DO NOT MANUFACTURE
PARTS TO THIS DRAWING**

SPECIFICATIONS SUBJECT TO CHANGE WITHOUT NOTICE DIMENSIONS ARE FOR REFERENCE ONLY

REV. A	S1	S2	EFL @ 587.6μm	9.5	 Edmund Optics®			
SHAPE	CONVEX	PLANO	BFL @ 587.6μm	6.51				
RADIUS	6.391	INFINITY	<div>THIRD ANGLE PROJECTION</div>		TITLE	12.5mm DIA, 0.66 NUMERICAL APERTURE NIR COATED, ASPHERIC LENS		
SURFACE QUALITY	60-40	60-40						
CLEAR APERTURE	90%	90%						
BEVEL MAX	PROTECTIVE AS NEEDED	PROTECTIVE AS NEEDED	ALL DIMS IN	mm	DWG NO	69862		SHEET 1 OF 1