

NOTES:

1. SUBSTRATE MATERIAL:
N-BK7
2. COATING (APPLY ACROSS CLEAR APERTURE)

S1 & S2: NIR I (600-1050nm)
R(AVG) ≤0.5% @ 600 - 1050nm

3. FINE GROUND SURFACE

4. RoHS COMPLIANT

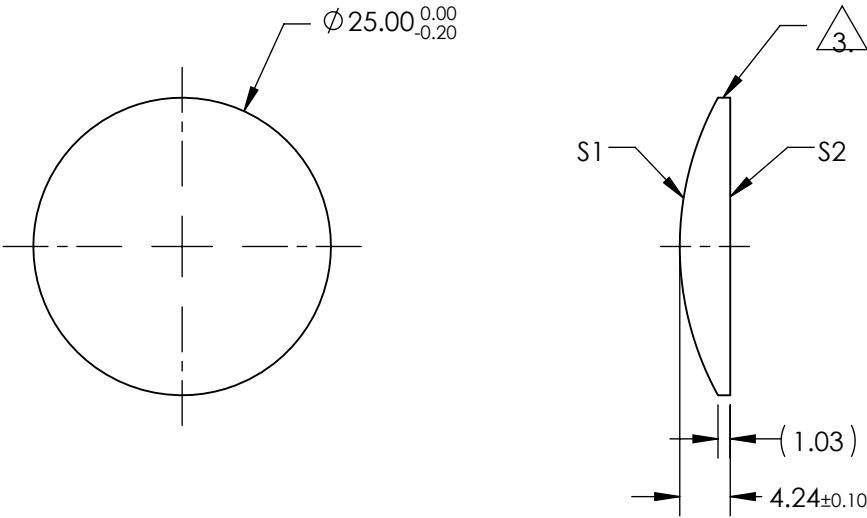

**FOR INFORMATION ONLY:
DO NOT MANUFACTURE
PARTS TO THIS DRAWING**

SPECIFICATIONS SUBJECT TO CHANGE WITHOUT NOTICE
DIMENSIONS ARE FOR REFERENCE ONLY

	S1	S2	EFL	50.00	 Edmund Optics®	
SHAPE	CONVEX	PLANO	BFL	47.20		
RADIUS	25.93	INFINITY			TITLE	25mm DIA X 50mm FL NIR I COATED, CYLINDER LENS
SURFACE QUALITY	60-40	60-40				
CLEAR APERTURE	$\varnothing 24.00$	$\varnothing 24.00$	ALL DIMS IN	mm	DWG NO	69753
BEVEL	PROTECTIVE AS NEEDED	PROTECTIVE AS NEEDED				SHEET 1 OF 1