

NOTES:

1. SUBSTRATE MATERIAL:  
N-BK7
2. COATING (APPLY ACROSS CLEAR APERTURE)
- S1 & S2: VIS-NIR (400-1000nm)  
R(ABS) ≤0.25% @ 880nm  
R(AVG) ≤1.25% @ 400 - 870nm  
R(AVG) ≤1.25% @ 890 - 1000nm
3. FINE GROUND SURFACE
4. RoHS COMPLIANT

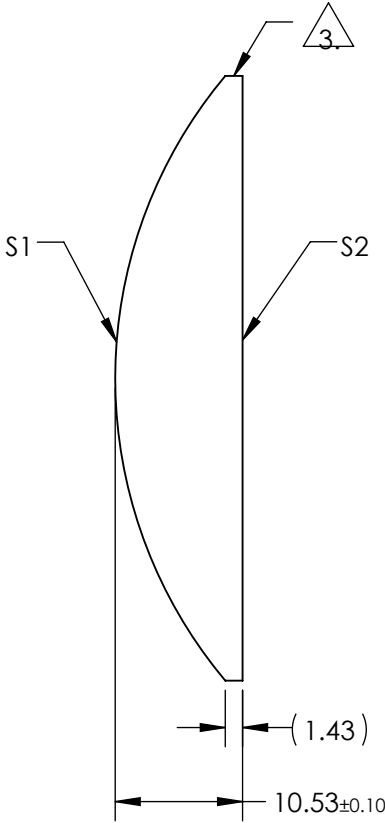
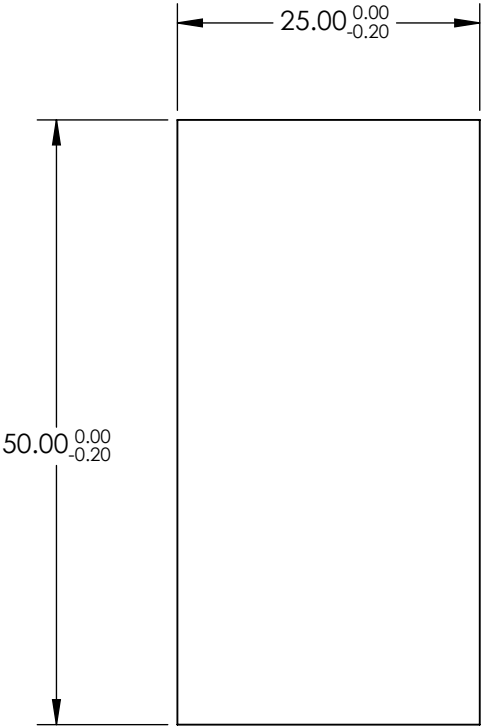

**FOR INFORMATION ONLY:  
DO NOT MANUFACTURE  
PARTS TO THIS DRAWING**

SPECIFICATIONS SUBJECT TO CHANGE WITHOUT NOTICE  
DIMENSIONS ARE FOR REFERENCE ONLY

	S1	S2	EFL	75.00	 Edmund Optics®		
SHAPE	CONVEX	PLANO	BFL	68.07			
RADIUS	38.89	INFINITY			TITLE	50mm H X 25mm L X 75mm FL VIS-NIR COATED, CYLINDER LENS	
SURFACE QUALITY	60-40	60-40					
CLEAR APERTURE	49.00 x 24.00	49.00 x 24.00			DWG NO	69788	
BEVEL	PROTECTIVE AS NEEDED	PROTECTIVE AS NEEDED					
					ALL DIMS IN	mm	