

NOTES:

1. SUBSTRATE
FUSED SILICA
2. SURFACE S2 TO BE PARALLEL TO SURFACE S1 TO WITHIN <3 ARCMIN
3. COATING (APPLY ACROSS COATING APERTURE):

S1: 515 HR Coating
R (ABS) > 99.80% @ 515nm @ 0-45° AOI

DAMAGE THRESHOLD,
PULSED: 10 J/cm², 20ns, 20Hz @ 515nm
CW: 1MW/cm² @ 515nm

S2: NONE

4. FINE GRIND SURFACE
5. POWER, IRREGULARITY, AND SURFACE QUALITY SPECIFICATIONS APPLY
ACROSS CLEAR APERTURE
6. CLEAR APERTURE AND COATING APERTURE ARE CENTERED ON SURFACES
7. APPLY ARROW ON EDGE WITH LASER ETCH, PENCIL, OR PERMANENT INK
POINTING TOWARDS SURFACE S1

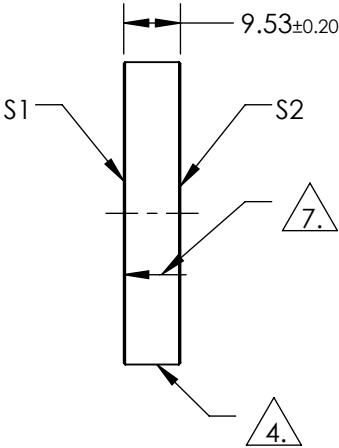
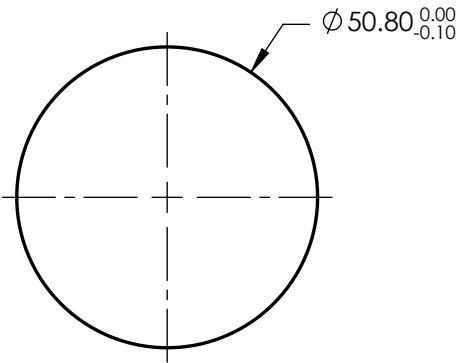

**FOR INFORMATION ONLY:
DO NOT MANUFACTURE
PARTS TO THIS DRAWING**

SPECIFICATIONS SUBJECT TO CHANGE WITHOUT NOTICE
DIMENSIONS ARE FOR REFERENCE ONLY

	S1	S2				
SHAPE	PLANO	PLANO	<div><div>THIRD ANGLE PROJECTION</div><div></div><div>TITLE</div><div>Ø50.8mm x 9.53mm, 515nm, Yb:YAG MIRROR 0-45° AOI</div><div>DWG NO</div><div>38886</div><div>SHEET 1 OF 1</div></div>			
SURFACE QUALITY	10-5	COMMERCIAL POLISH				
SURFACE FLATNESS	0.10 WAVE	N/A				
MIN CLEAR APERTURE	Ø40.64	N/A				
MIN COATING APERTURE	Ø45.72	N/A				
BEVEL	PROTECTIVE AS NEEDED	PROTECTIVE AS NEEDED	ALL DIMS IN	mm		

Edmund Optics®